

PD130 RGB SERIES

User's Manual & Installation Guide

Index

V.1.0

- | | | | |
|---|---|----|--|
| 1 | Cover & Index | 6 | Connection Diagram |
| 2 | Safety Information / Warning / Warranty / Marking | 7 | Installation Instruction |
| 3 | Explanation / Dimension | 9 | Ordering Information Accessories & Recommended Products |
| 4 | Product Specifications | 10 | Back Cover |
| 5 | Standart DMX Wiring Diagram | | |

Congratulations on choosing a HERA product!
We thank you for your custom.

Please note that this product, as all the others in the rich HERA range, has been designed and made with total quality to ensure excellent performance and best meet your expectations and requirements. Carefully read this instruction manual in its entirety and keep it safe for future reference. It is essential to know the information and comply with the instructions given in this manual to ensure the fitting is installed, used and serviced correctly and safely. HERA disclaims all liability for damage to the fitting or to other property or persons deriving from installation, use and maintenance that have not been carried out in conformity with this instruction manual, which must always accompany the fitting. HERA reserves the right to modify the characteristics stated in this instruction manual at any time and without prior notice.

Safety Information

Caution – unplug the power supply from the main power before connecting any cables as this can damage the products.

Caution – avoid looking directly into the led light source at close range for your own safety.

Any people installing this product should comply with local standards and regulations and must be qualified for the handling of electrical equipment.

- Do not attempt to install or use the product until installation instructions and safety labels are fully understood. This product is designed for indoor and outdoor usage.
- Ensure product operates within the specified temperature range.
- Do not attempt to open the product.
- Do not use the product if the power cables are damaged.
- Only use product for specified voltage.
- Always maintain connection to ensure waterproofing.
- If the product has been subjected to drastic temperature variances, for example, following transportation, do not connect the fixture until it has reached room temperature, as moisture condensation may cause electric shock and product damages.
- When installing the products and system power supplies, please ensure they will not be exposed to moisture and extreme heat (and direct sunlight for outdoor products). Besides, keep a clean operating environment for the fixtures and system power supplies.
- Please study this Installation Guide thoroughly and check the latest Technical Specification Sheets available from the our website www.heraled.com before setup.
- Any non-compliance of the Installation Guide will void the Hera warranty.

Warning



Risk of
Electric
Shock



Warning!
Refer to User
Manual.



Do Not Open
Products



Not Suitable
for Household Room
Illumination



DIRECTIVE 2012/19/EU
Waste Electrical
and Electronic Equipment

Warranty

Hera warrants the products for a period of five (5) years from date of purchase, provided that the purchased items are used under the conditions stated in this user manual.

Marking



RoHS
compliant

IP66



PD130 RGB SERIES

Explanation

PD130 RGB Series is designed use on curved surface where linear lighting systems cannot turn. Splendid effects can be animated with large fixtures without limitation of geometry, shape and range. PD 130 consists of 3 LEDs. 1 Master unit can be used with max 49 slave units. Slave units are addressed via master unit automatically. It has IP67 class protection markings and high UV resistance.

- It communicates with other fixtures by standard DMX 512 and RDM protocols without requirements of any special communication protocols or production identity. It can be addressed remotely as a group. By courtesy of this feature pixel mapping and addressing are easier.
- Maximum 50 pixels can be linked in snake mode.
- This product is recommended to use with cable no longer than 10m due to its 12VDC working voltage.
- Working status of fixtures, local temperature values, voltage input and output, serial number and DMX address can be monitored. User is informed by mail and system can response automatically according to data.
- Fixtures work compatibly with Madrix® software and hardware. You can choose fixtures in library in order to have easy pixel mapping.
- Fixtures are designed for harsh outdoor condition and resistant against vibration, impact and thermal shock owe to their solid PC structures, special filling material and IP66 class protection markings.
- Power and data are transmitted by input and output connectors. IP68 screw type connectors can be installed easily. Additional junction boxes are not needed with input and output.
- There are holes 4 mm in diameter for installation right and left side of fixture.
- Fixtures are produced in RAL9005 black color but according to customers' demand fixture can be painted to different RAL colors.

Dimension

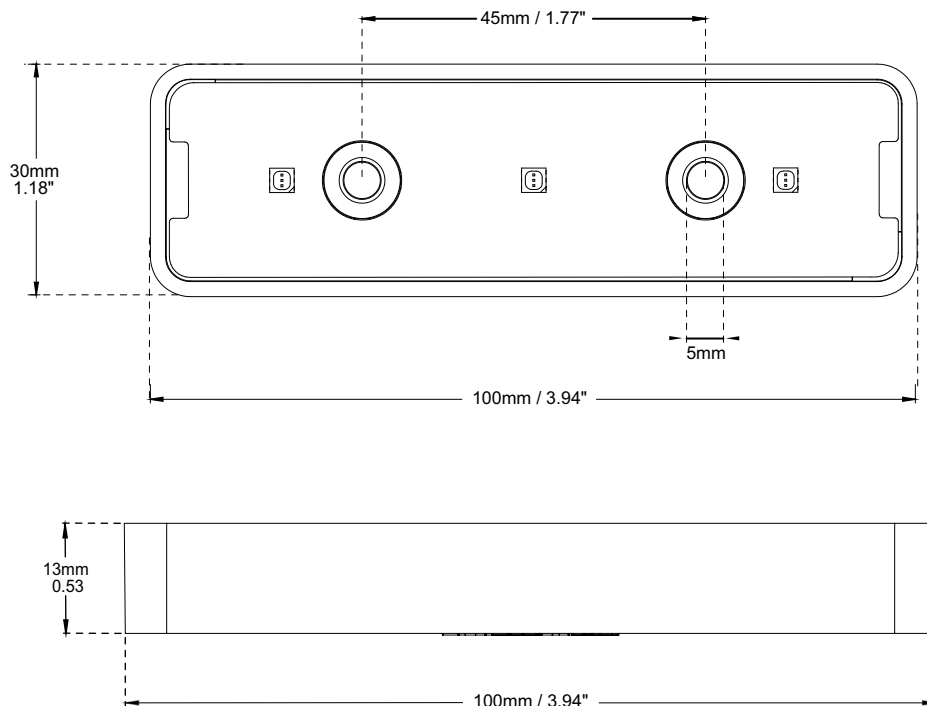

PD130 RGB SERIES

Product Specifications

| | |
|--------------------------------|--|
| Light Source: | 3pcs High intensity 3 in 1 Chip RGB LEDs |
| Lumen Maintenance: | 60.000+ hours L70 @ 25° C (full output) |
| Color Range: | 16.7 Million additive RGB colors |
| PWM Frequency: | 1,600Hz flicker free dimming to 0.1% |
| Color Resolution: | 3 x 14-bit (Gamma correction) |
| Viewing Angle: | 110° |
| Luminous Intensity: | Please check IES and LTD files out |
| Efficacy: | Please check IES and LTD files out |
| Maximum in Chain: | Max 50pcs |
| Operating Voltage: | 12VDC |
| Power Consumption: | 0.85W (all LEDs on) |
| Control Interface: | Master USITT DMX 512 A, Slave SPI |
| Addressing: | Master RDM (Group of Remote Addressable Systems), Slave Auto Addressing |
| Housing: | Die-Cast Polycarbonate Body |
| Environment: | IP66, IK09 |
| Operating Temperature: | -40°C - 50°C - (-40° - 122° F) |
| Storage Temperature: | -40°C - 85°C - (-40°C - 185° F) |
| Dimensions (H x W x D): | 13x100x30 mm (0.51x3.93x1.18 in) |
| Weight: | 0.035 kg (0.077 lb) |
| Certification: | EU Safety: EN 60950-22:2006 + AC: 2008, EN 60950-1:2006+A2:2013, EN 62262:2002 |
| | EU EMC: EN 55024:2010/A1:2015, EN 55032:2015/AC:2016-07, -EN 61000-4-3, EN 61000-4-4, EN 61000-4-6, EN 61000-4-8 |
| | US Safety: UL 60950-22, UL 60950-1 |
| | US EMC: FCC Part 15 Class A |

PD130 RGB SERIES

Standart DMX Wiring Diagram

Indoor Zone

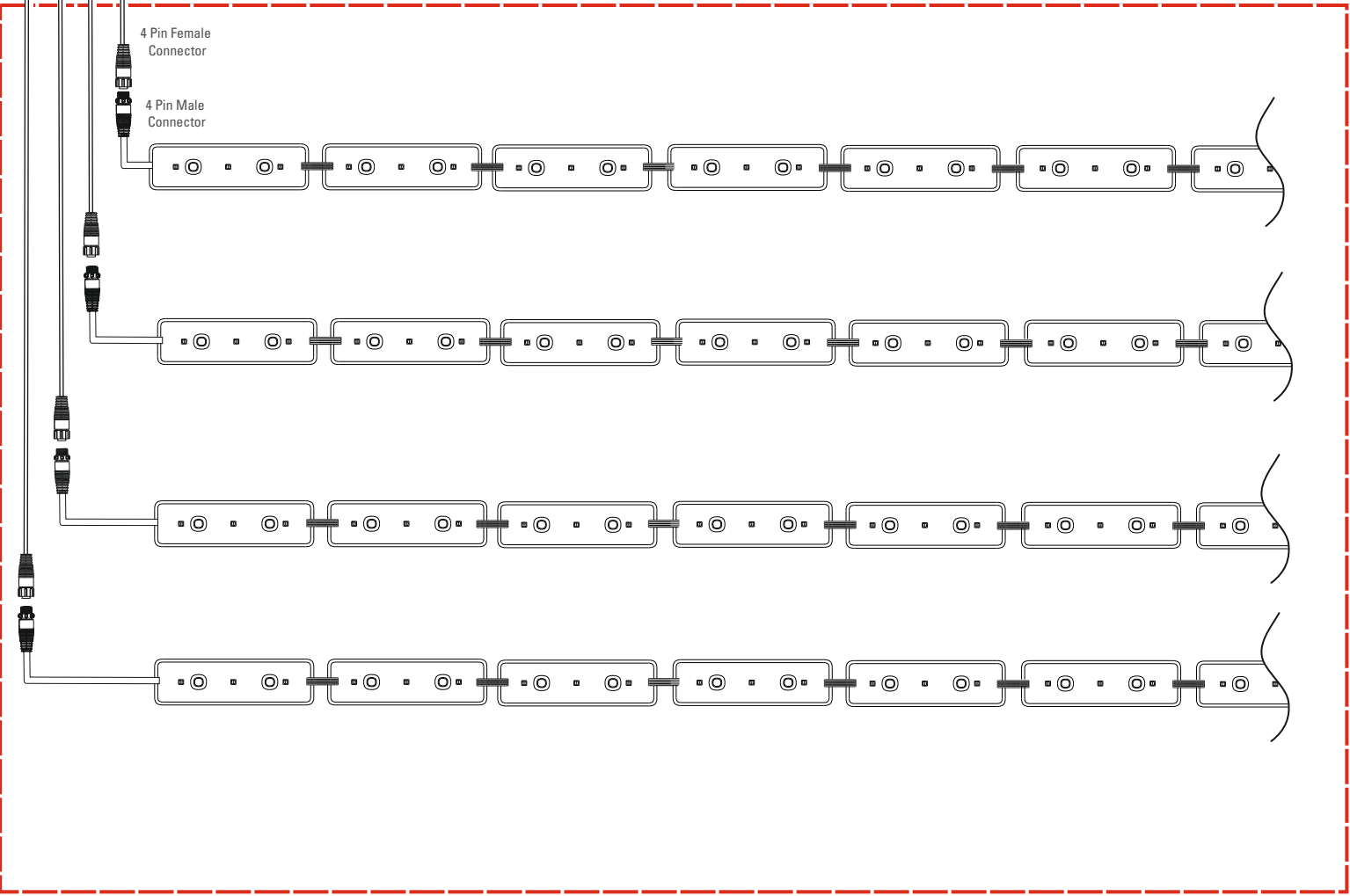
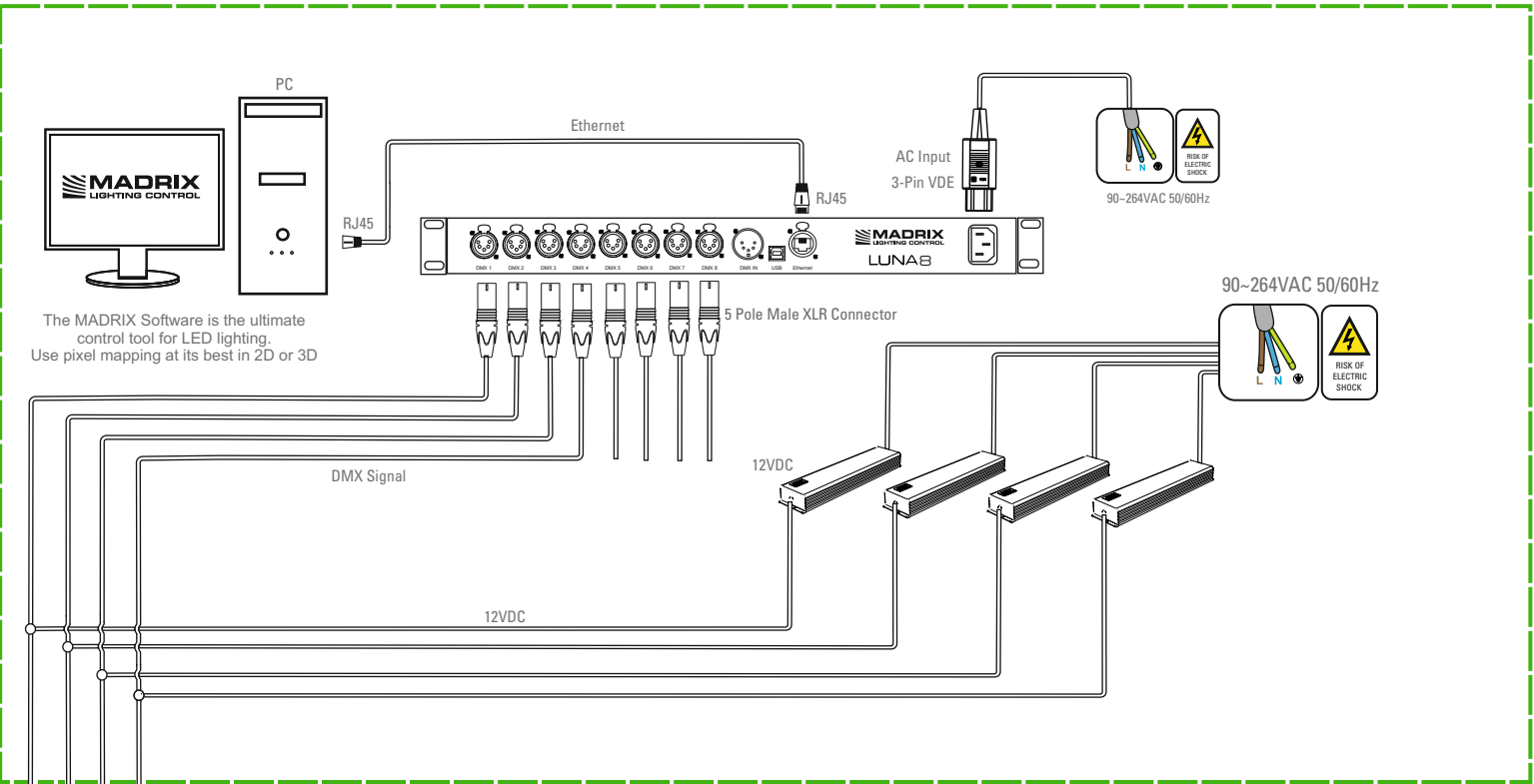

Outdoor Zone

Connection Diagram

Connect the connector as shown at figure

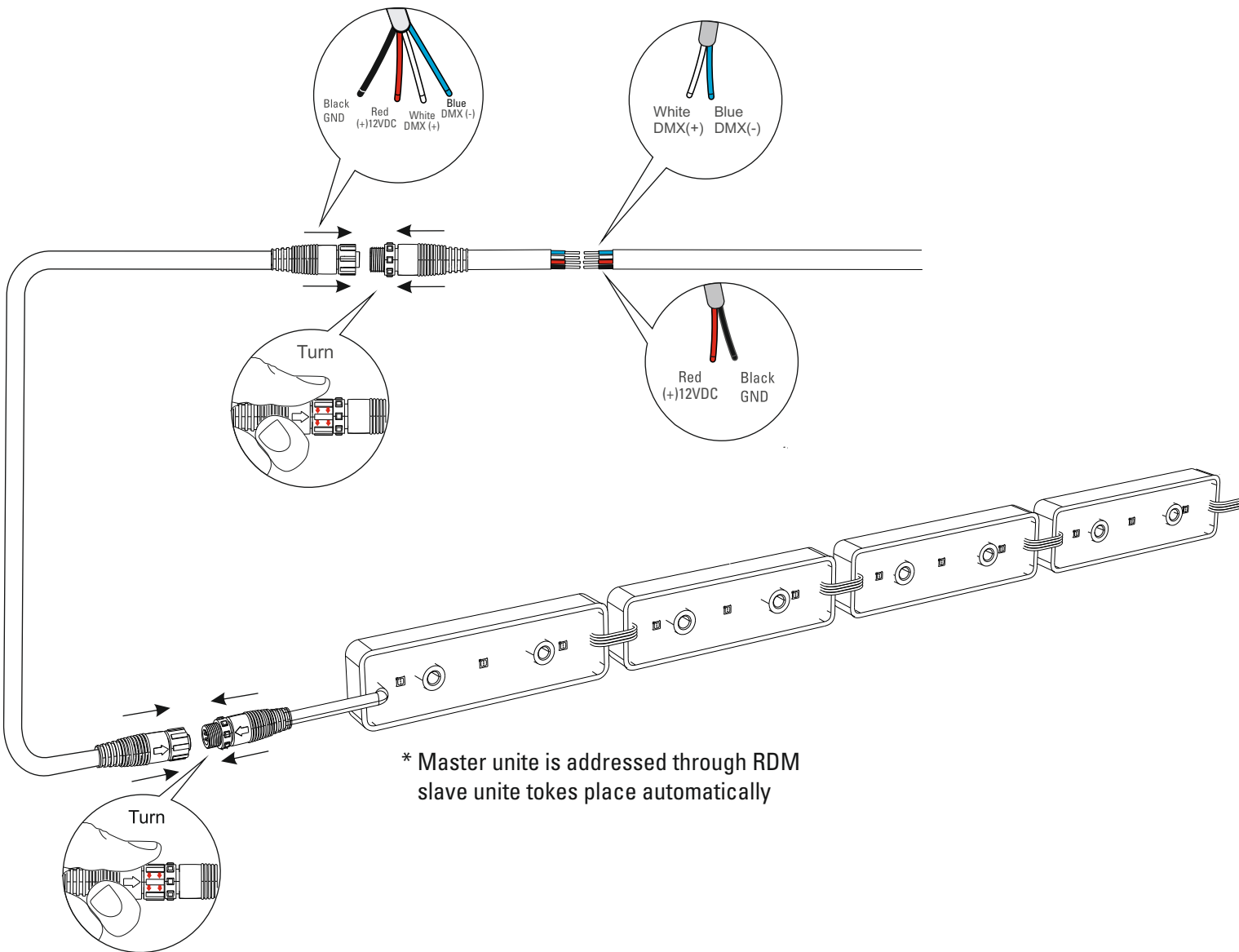

Installation Instruction

Warning!

*Do not twist the cable

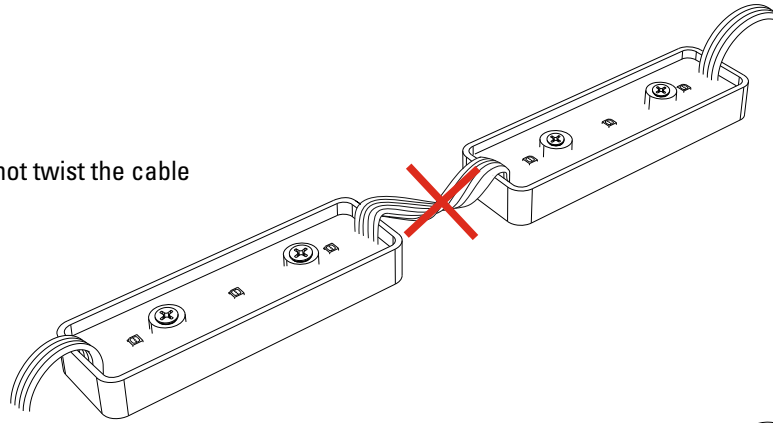

*Install the product without stretching the cable

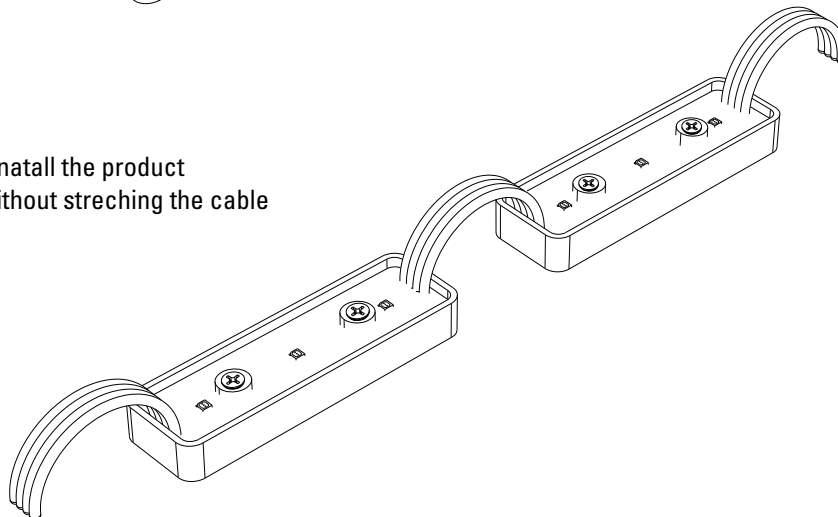

* Make space as 20mm

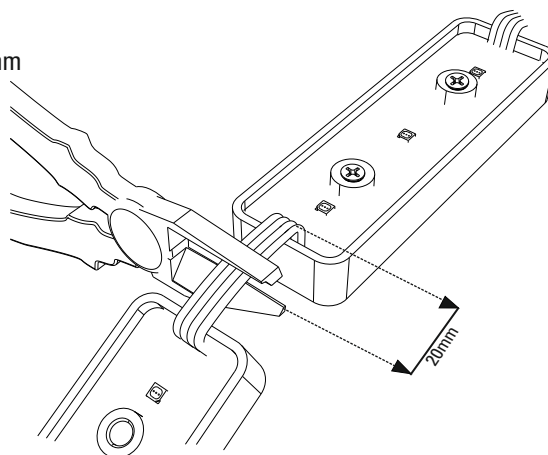

Installation Instrucion

1 Assemble the product by connecting master unite

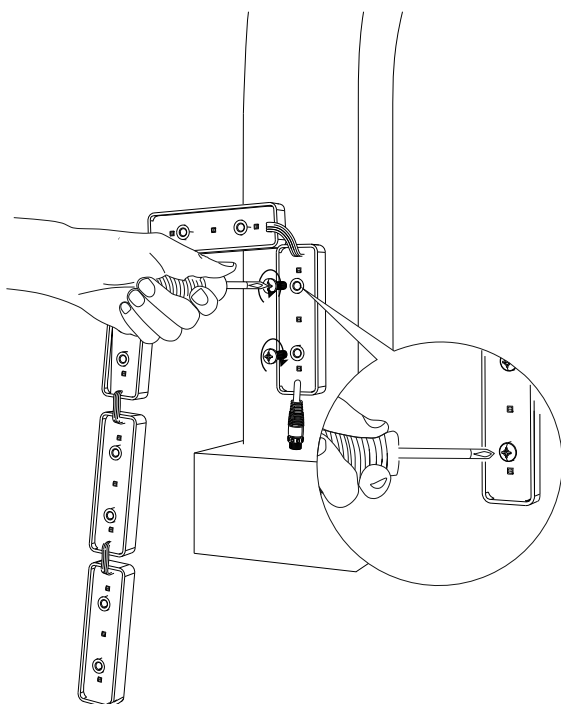

2 Use clamb or screw

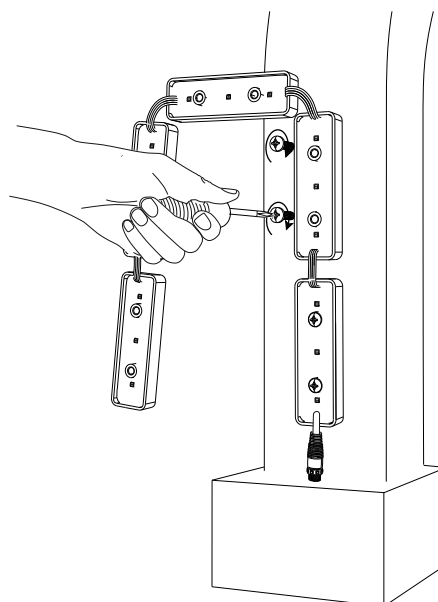

3 Cut the remaining parts of the cable and isolate with RTV silicon

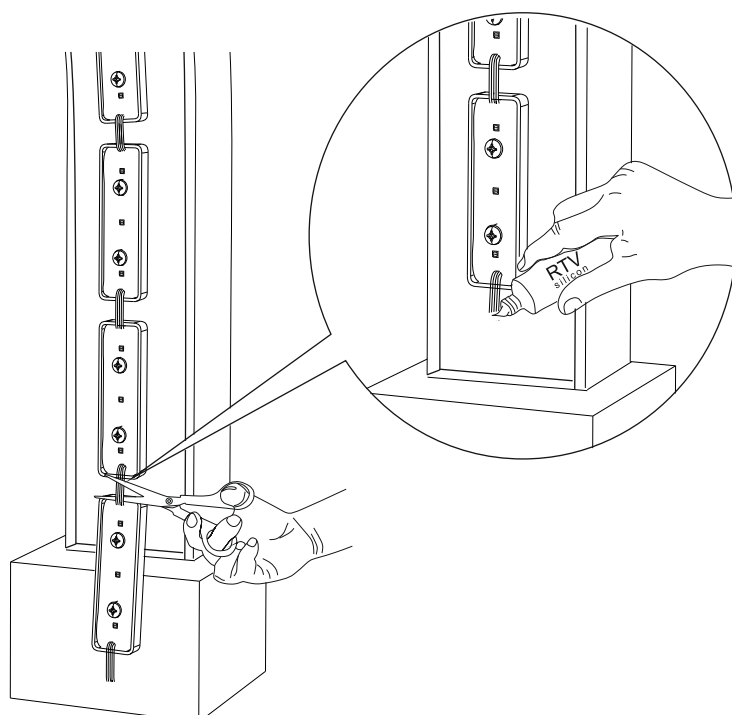

4 Finished installation

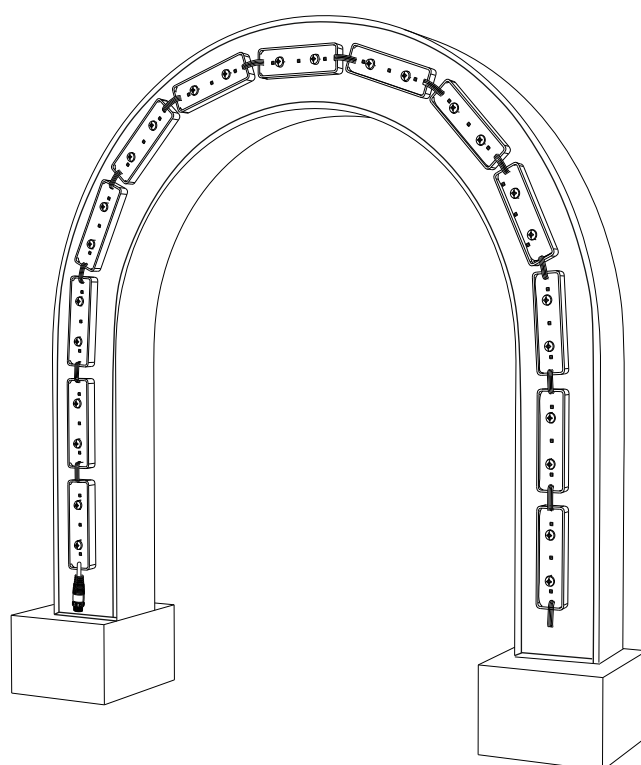

Ordering Information

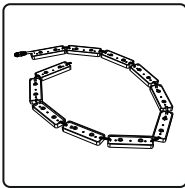

- P01010085-20 PD130-RGB 3Ch. DMX 1 Master & 19 Slave Sets
- P01010085-30 PD130-RGB 3Ch. DMX 1 Master & 29 Slave Sets
- P01010085-40 PD130-RGB 3Ch. DMX 1 Master & 39 Slave Sets
- P01010085-50 PD130-RGB 3Ch. DMX 1 Master & 49 Slave Sets
- P01010085 PD130-RGB 3Ch. DMX Master Module
- P01011085 PD130-RGB 3Ch. DMX Slave Module

*Standart product codes that we provided is above. Please contact us for special orders.

Accessories

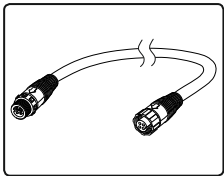

P20022
4 Pin Leader Cable 2 Meter

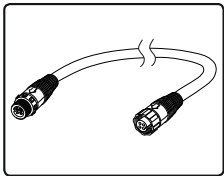

P20023
4 Pin Leader Cable 5 Meter

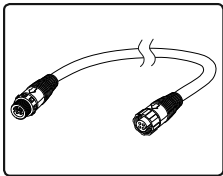

P20024
4 Pin Leader Cable 10 Meter

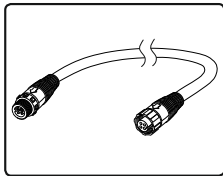

P20025
4 Pin Leader Cable 15 Meter

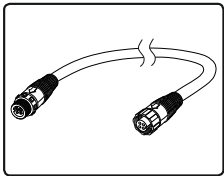

P20026
4 Pin Leader Cable 20 Meter

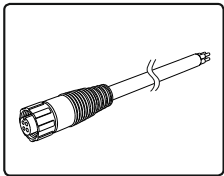

P20027
4 Pin Female
IP67 Cable & Connector 30cm

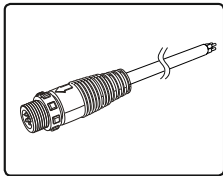

P20028
4 Pin Male
IP67 Cable & Connector 30cm

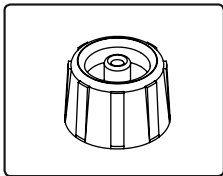

P20039
Waterproof Cap For 4 Pin

